

COPYRIGHT RAMBOLL UK LIMITED. ALL RIGHTS RESERVED. THIS DOCUMENT IS ISSUED FOR THE PARTY WHO COMMISSIONED IT AND FOR THE SPECIFIC PURPOSE CONNECTED WITH THE PROJECT ONLY. IT SHOULD NOT BE RELIED UPON BY ANY OTHER PARTY OR USED FOR ANY OTHER PURPOSE. RAMBOLL ACCEPTS NO RESPONSIBILITY OR LIABILITY WHICH MAY ARISE FROM RELIANCE OR USE OF THIS DOCUMENT OR THE DATA CONTAINED HEREIN BY ANY OTHER PARTY OR FOR ANY OTHER PURPOSE.

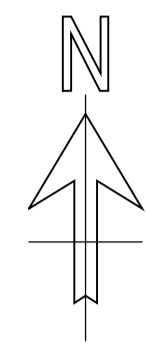

ROAD MARKING SCHEDULE				
DIMENSIONS GIVEN IN THE SCHEDULE TO BE COMPARED AGAINST EXISTING MARKINGS. PROPOSED WORKS TO BE ADJUSTED WHERE REQUIRED TO MATCH EXISTING MARKINGS				
Marking Ref.	Outline Detail	Colour	Details	Comments
1018.1	Parking Prohibited	Yellow	50mm WIDE LINE (PAIR) 50mm GAP	
1018.2	Stopping Prohibited	Red	50mm WIDE LINE (PAIR) 50mm GAP	
1025.1	Bus Stop	Yellow	1000mm DASH, 600mm GAP, 100mm WIDE. Text 'BUS STOP' 1600mm HIGH	
1028.2	Taxi Bays	Yellow	600mm DASH, 600mm GAP, 50mm WIDE. Text 'TAXIS' 400mm HIGH	
1028.4	On street Bays	White	600mm DASH, 600mm GAP, 50mm WIDE. Text 400mm HIGH	No text to Parking Bays
1029	Pedestrian Guidance Text	White	Text 'LOOK BOTH WAYS' 280mm HIGH	
1048	Bus and Cycle lane text	White	Text 'BUS AND cycle symbol LANE' 1600mm HIGH	
1049A	Bus Lane Boundary	White	300mm WIDE CONTINUOUS LINE	

- Notes
- THIS DRAWING IS BASED ON THE FOLLOWING LDA DRAWINGS:
SHR-LDA-SB-LG-DR-L-110-101,
SHR-LDA-SB-LG-DR-L-110-102,
SHR-LDA-SB-01-DR-L-110-103,
SHR-LDA-SB-07-DR-L-110-104,
SHR-LDA-SB-12-DR-L-110-106,
SHR-LDA-SB-13-DR-L-110-107
AND PLOWMAN CRAVEN UNDERGROUND SERVICES SURVEY 40652-01T REVISION A
 - EXACT EXTENTS OF TIE IN TO BE AGREED ON SITE AND DEPENDENT OF CONDITION OF KERBS AND CARRIAGEWAY FOLLOWING REMOVAL OF EXISTING FEATURES.
 - THE CONTRACTOR SHALL BE RESPONSIBLE FOR LOCATING AND IDENTIFYING EXISTING SERVICES PRIOR TO COMMENCEMENT OF WORKS AND FOR PROVIDING ANY NECESSARY PROTECTION TO SUCH SERVICES. WHERE NECESSARY, CONTRACTOR SHALL LIAISE WITH RELEVANT SERVICE OWNERS.
 - PARKING RESTRICTIONS TO BE AGREED WITH READING BOROUGH COUNCIL.
 - ROADMARKING DIMENSIONS AND SPECIFICATIONS TO MATCH EXISTING AND TO FOLLOW READING BOROUGH COUNCIL REQUIREMENTS.
 - WHERE CONDITION IS DEEMED SUITABLE FOR RE-USE, EXISTING KERBS REMOVED AND SET ASIDE DURING SITE CLEARANCE WORKS CAN BE RE-USED.
 - FOR HIGHWAY BOUNDARY DEMARCATION, REFER TO NOTE 6 ON DRAWING SHR-RMB-XO-EX-DR-03-100522

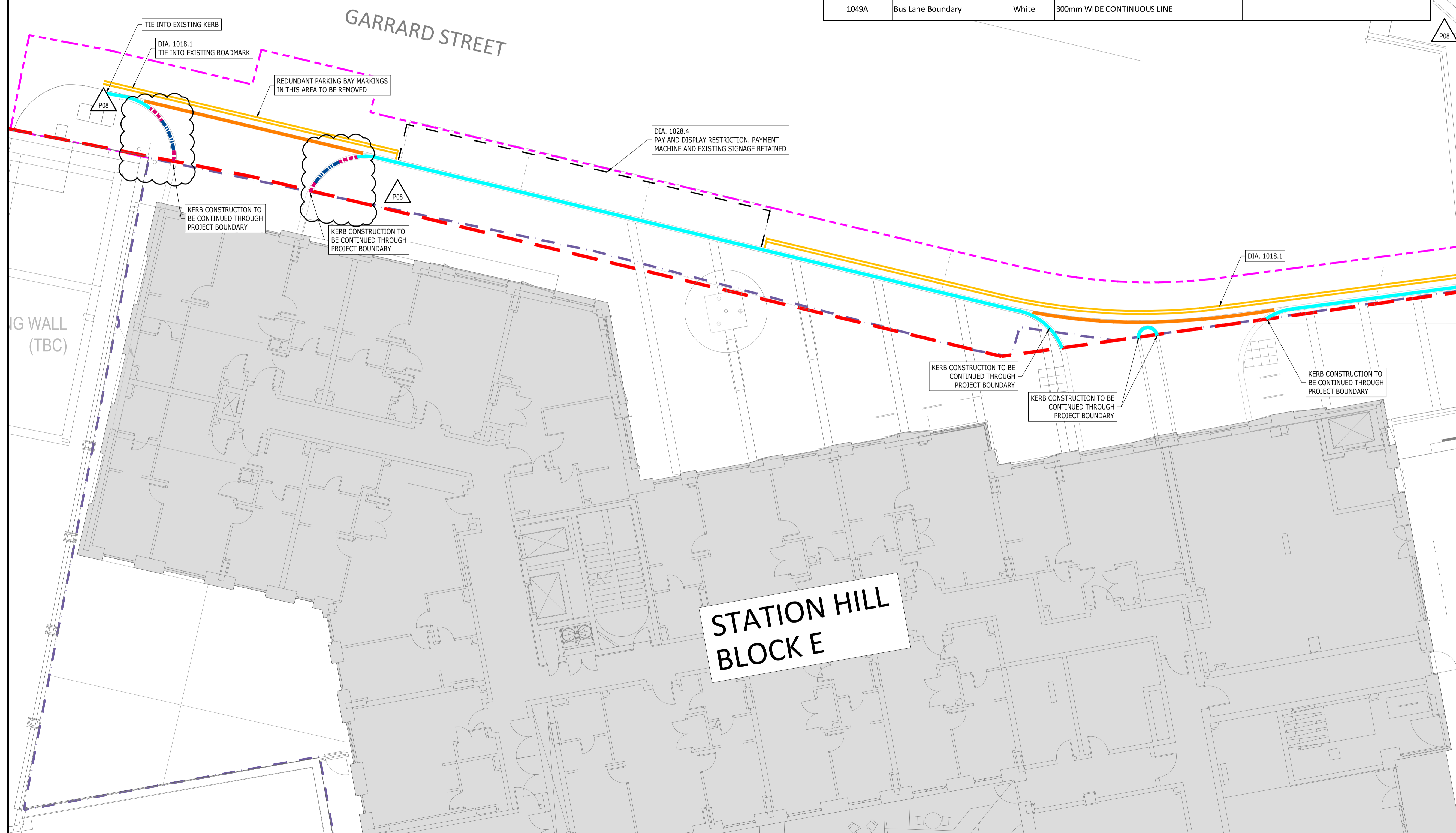

- PROPOSED EXTENTS OF S278 WORKS
- STATION HILL SITE BOUNDARY
- ADOPTED HIGHWAY BOUNDARY BASED ON 'REVISED MAP - STATION HILL DEVELOPMENT SITE' RECEIVED 16.04.2020 AND SUBSEQUENT CLIENT DISCUSSION.
- 125mm WIDE x 255mm CONSERVATION KERB WITH 125 UPSTAND. REFER TO RBC DETAIL 15975/SD1101 Fig 1.
- 125mm WIDE CONSERVATION TRANSITION KERB CENTRE. REFER TO RBC DETAIL 15975/SD1101 Fig 2A. KERB HAUNCH SET TO ALLOW INSTALL OF BLOCK PAVING
- 125 x 125mm CONSERVATION KERB CENTRE STONE LAID WITH 5mm UPSTAND. REFER TO RBC DETAIL 15975/SD1101 Fig 2A. KERB HAUNCH SET TO ALLOW INSTALL OF BLOCK PAVING
- 50mm WIDE FLAT TOP PRECAST CONCRETE EDGING. REFER TO SHR-RMB-XO-EX-DR-C-03-100701
- DIAGRAM 1025.1
- DIAGRAM 1018.1

P08	MINOR UPDATES AS INDICATED	18.11.2021	GC	KJ
P07	KEY UPDATED	09.08.2021	GC	KJ
P06	UPDATED FOR RBC COMMENTS	08.07.2021	GC	KJ
P05	VEHICLE BAY MARKINGS CLARIFIED	16.04.2021	MES	GC
P04	UPDATED FOR RBC COMMENTS	30.03.2021	MES	GC
P03	UPDATED FOR STANTEC COMMENTS	16.12.2020	MES	GC
P02	SITE BOUNDARY UPDATED. WORKS UPDATED TO SUIT	12.08.2020	EN	GC
P01	PRELIMINARY ISSUE	07.02.2020	EN	JL

PRELIMINARY

STATION HILL
READING



SOUTH SITE S278 WORKS
PROPOSED KERB, TRAFFIC
SIGN AND ROAD MARKING
SHEET 2

Project No:	Scale (B1):	Drawn:	Date:
1620004716	1:100	EN	AUG 2020
Drawing No:	Rev:		
SHR-RMB-XO-EX-DR-C-03-100522	P08		